

# Welcome to your RBC Vx 510 Terminal

## 1. Package contents



- 1 Vx 510 Terminal
- 2 Power cord / Telephone cord / LAN cable
- 3 PINPad (upon request)

## 2. Connecting your terminal

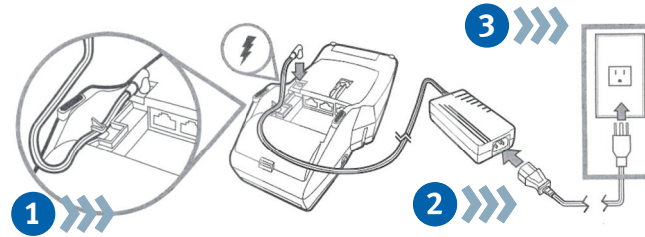

- 1 Attach the power line to the bottom of the terminal, ensuring that the cord is passed under the terminal clip.
- 2 Connect the power cord to the power adaptor
- 3 Plug into the wall socket.

## 3. Installing the paper

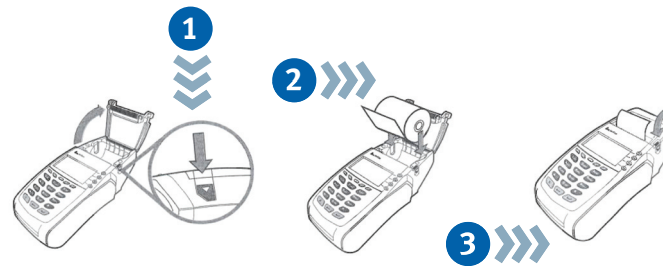

- 1 Push down the button to the right side of the printer cover, to open.
- 2 Place the paper roll into the terminal.
- 3 Push down the cover to close.

## 4. Connecting the PINPad (if required)

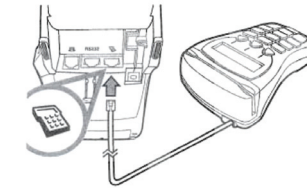

- 1 Attach the RS 232 end of the PINPad cord to the PINPad port on the bottom of the terminal.

## 5. Connecting the telephone cord or LAN cable

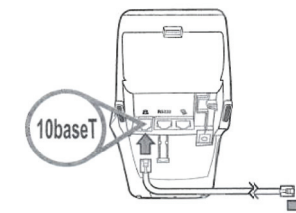

- 1 For LAN - Plug the LAN cable into the 10baseT port of the terminal and the other end into the LAN device.

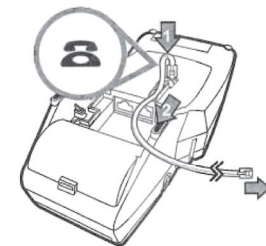

- 2 For Dialup - Plug the phone line into the phone port under the terminal and into the wall outlet.

## 6. Using your terminal



- 1 Place the terminal on a flat solid surface.
- 2 Swipe the bank card through the card slot and perform a transaction.

### Disclaimer

The content of this publication is for the general guidance and benefit of our clients. While efforts are made to ensure the accuracy and completeness of the information at the time of publication, errors and omissions may occur. You should not act or rely on the information herein without seeking the advice of a professional. RBC Royal Bank and its affiliates specifically disclaim any liability which is incurred as a consequence, directly or indirectly, of the use and application of any of the contents of this publication. RBC Royal Bank reserves the right to amend the terms and conditions stated in this publication.



RBC Royal Bank

# RBC Vx 510 Terminal instructions

RBC Royal Bank

